

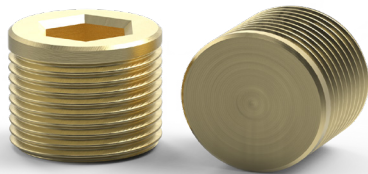

PRODUCT TYPE SPA & SPB

Metallic Stopping Plugs

Ex db : Ex eb : Ex ta : IP66 : Class I Div 1 : AEx db : AEx eb : AEx ta



EXAMPLE PART NUMBERING:
SPA0BD/NP/M20

| | |
|------------|---|
| SP | Stopping (Blanking) Plug |
| A | Type A External Fixing (A) - Type B Internal Fixing (B) |
| O | No IP O-ring |
| B | Brass (B) - Stainless Steel (S) - Aluminium (A) |
| D | Multiple Certification |
| NP | Nickel Plated |
| M20 | Male Thread |

| | |
|-------------------------------|-------------------------------------|
| IP RATING: | IP66 & Type 4X |
| OPERATING TEMPERATURE: | O-ring - None -100°C to +400°C |
| MATERIALS: | Brass, Stainless Steel or Aluminium |
| PLATING: | Electroless Nickel |

Male threads are manufactured in accordance with:-

- ISO Metric threads to ISO 965-1, ISO 965-3, BS3643 and IEC 60423
- NPT and NPS threads are in accordance to ANSI B1.20.1
- PG threads to DIN40430
- ET threads to Imperial Conduit BS31
- ISO Pipe Parallel to ISO 228 and BS2779 (BSPP, G, R, PF & Tpy 6)
- ISO Pipe Taper to ISO 7-1 and BS21 (BSPT, Gc, Gk, Rk, PT & Kmpy 6)

STOPPING PLUG INFORMATION TABLE
(ALL DIMENSIONS IN mm)

| ISO Metric Thread | Hex Socket A/F | Overall Length | Weight (Kgs) | NPT Thread | Hex socket A/F | Overall Length | Weight (Kgs) |
|-------------------|----------------|----------------|--------------|------------|----------------|----------------|--------------|
| M12 | 6.0 | 17.0 | 0.011 | 1/4" | 6.0 | 11.2 | 0.009 |
| M16 | 8.0 | 17.0 | 0.025 | 3/8" | 8.0 | 11.3 | 0.030 |
| M20 | 10.0 | 17.0 | 0.035 | 1/2" | 10.0 | 14.5 | 0.030 |
| M25 | 12.0 | 17.0 | 0.060 | 3/4" | 12.0 | 14.8 | 0.050 |
| M32 | 12.0 | 17.0 | 0.105 | 1" | 12.0 | 18.5 | 0.110 |
| M40 | 14.0 | 17.0 | 0.170 | 1 1/4" | 14.0 | 19.1 | 0.180 |
| M50 | 17.0 | 17.0 | 0.265 | 1 1/2" | 17.0 | 19.5 | 0.250 |
| M63 | 17.0 | 17.0 | 0.450 | 2" | 17.0 | 20.5 | 0.430 |
| M75 | 19.0 | 17.0 | 0.600 | 2 1/2" | 19.0 | 30.5 | 0.930 |
| M80 | 22.0 | 22.0 | 0.750 | 3" | 22.0 | 32.1 | 1.490 |
| M85 | 22.0 | 22.0 | 0.880 | 3 1/2" | 22.0 | 33.4 | 2.060 |
| M90 | 22.0 | 22.0 | 0.940 | 4" | 22.0 | 34.7 | 2.760 |
| M100 | 22.0 | 22.0 | 1.030 | | | | |

NOTES

- Assembly instructions must be read prior to installation and adhered to in full.
- For Ex db applications female threads must comply with clause 5.3 of IEC 60079-1.
- For Ex nR applications parallel entry threads must be installed with a suitable entry thread seal.
- ATEX / IECEx versions are supplied as standard.
- Aluminium versions are not suitable for Group 1 Mining applications.
- Only products with Metric and NPT threads are marked with CSA approval.
- Brass products are not marked or intended to be used in Class I Division 1 installations.
- Peppers supply products with parallel entry threads that conform to the flameproof threaded joint requirements of IEC/EN 60079-1 and other equivalent standards. We usually incorporate a thread run out according to the general machining techniques and will not have a full form thread for the entire length. Peppers Cable Glands Limited will not be held responsible for clients' installations where this has not been taken into account.
- Where approval in addition to UKEX, ATEX, IECEx and CSA is required, this must be clearly requested at time of enquiry / order.

CERTIFICATION:

| | |
|-------------------------|--|
| UKEX | I M2 II 1D 2G Ex db I Mb / Ex db IIC Gb / Ex eb I Mb / Ex eb IIC Gb / Ex ta IIIC Da |
| ATEX | I M2 II 1D 2G Ex db I Mb / Ex db IIC Gb / Ex eb I Mb / Ex eb IIC Gb / Ex ta IIIC Da |
| IECEX | IECEX Ex db I Mb / Ex db IIC Gb / Ex eb I Mb / Ex eb IIC Gb / Ex ta IIIC Da |
| CEC - Canada | Ex db IIC Gb / Ex eb IIC Gb / Ex ta IIIC Da Class I Division 1, Groups A, B, C & D Class II Division 1, Groups E, F & G Class III, Type 4X |
| NEC - USA | Class I Zone 1 AEx db IIC Gb / AEx eb IIC Gb / Class II Zone 20 AEx ta IIIC Da Class I Division 1, Groups A, B, C & D Class II Division 1, Groups E, F & G Class III, Type 4X |
| EAC | PB Ex d I Mb / 1Ex d IIC Gb X / PT Ex e I Mc / 1Ex e IIC Gb X / Ex tb IIIC Db X |
| INMETRO - Brazil | Ex db I Mb / Ex db IIC Gb / Ex eb I Mb / Ex eb IIC Gb / Ex ta IIIC Da |
| CCC - China | Ex d I Mb / Ex d IIC Gb / Ex e I Mb / Ex e IIC Gb / Ex tD A20 |
| UKRAINE | I M2 Ex db I Mb / Ex eb I Mb / II 2GD Ex db IIC Gb / Ex eb IIC Gb / Ex tb IIIC Db |
| CCoE - India | Ex db I Mb / Ex db IIC Gb / Ex eb I Mb / Ex eb IIC Gb |
| ABS | Specified ABS Rules |
| LLOYD'S | Ex db I Mb / Ex db IIC Gb / Ex eb I Mb / Ex eb IIC Gb / Ex ta IIIC Da |
| RS - Russia | Ex d IC / Ex d IIC / Ex e IC / Ex e IIC / Ex tb IIIC |

CERTIFICATION No:

| | |
|-------------------------|-------------------------|
| UKEX | CML 21UKEX1039X |
| ATEX | CML 19ATEX1089X |
| IECEX | IECEX CML 19.0022X |
| CEC - Canada | CSA 2310046 |
| NEC - USA | CSA 2310046 |
| EAC | RU C-GB.BH02.B.00693-18 |
| INMETRO - Brazil | NCC 13.2189 X |
| CCC - China | 2021312313000377 |
| UKRAINE | CL 18.0320 X |
| CCoE - India | PESO P494321/2 |
| ABS | 20-LD1944057-PDA |
| LLOYD'S | LR2124442TA |
| RS - Russia | 19.00189.278 |